

TRAILHEAD
HOMESITE 11

0.41 hectares · 4,110 m²

1.02 acres

BUILDING ENVELOPE 0.30 acres | 1,210 m²

HOMESITE FRONTAGE 42.0 m | 137.8 ft

SETBACKS

Front yard: 15.0 m | 49.2 ft

Rear yard: As per homesite plan

Side yard (left): 15.0 m | 49.2 ft

Side yard (right): 6.0 m | 19.7 ft

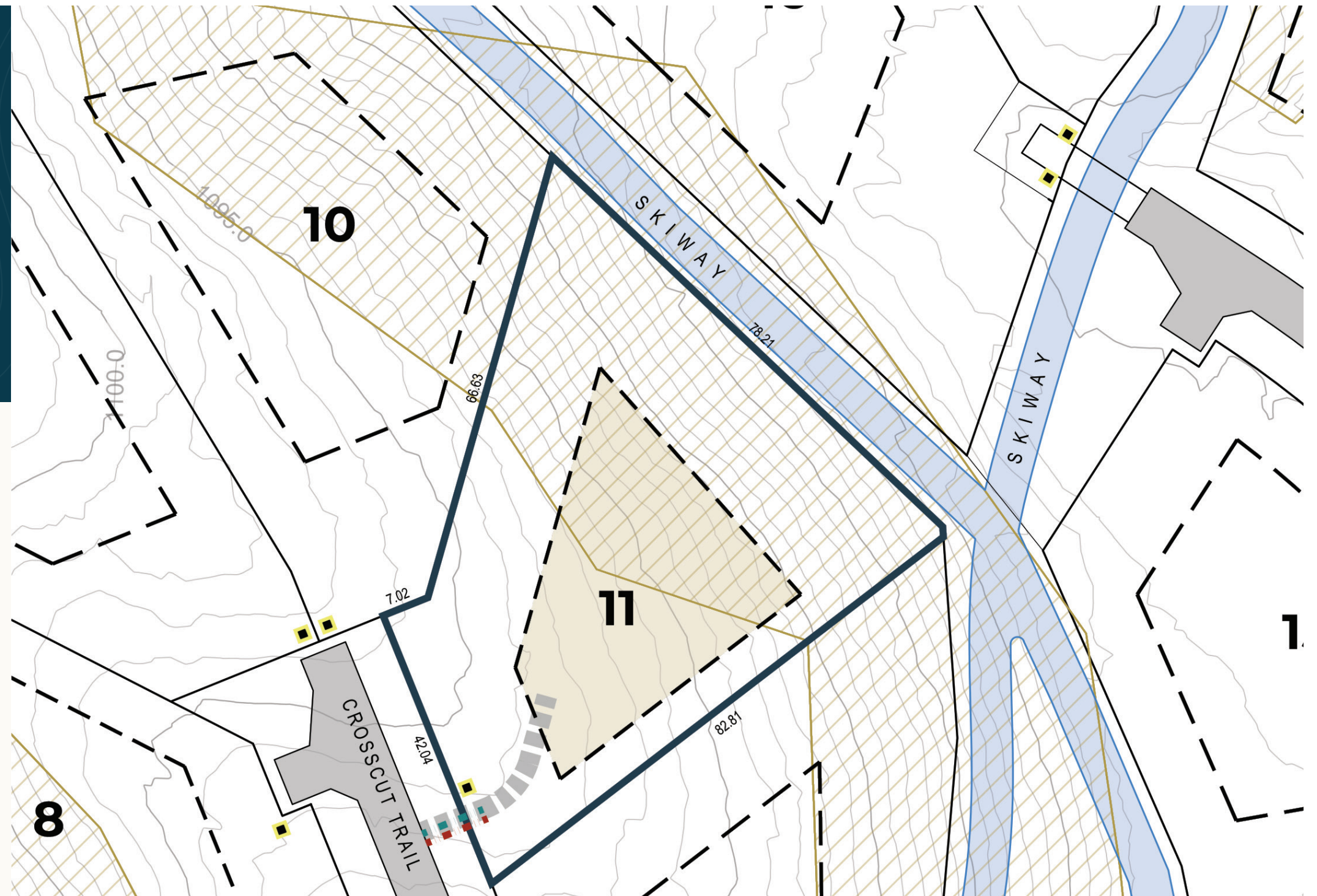

Property Boundary
Building Envelope

Required Driveway Location
Entry monument & light

Water service location
Sewer service location

Geohazard Zone II
Conditionally suitable for residential structures; site specific review required

Geohazard Zone IIIB
Unsuitable for residential structures

All dimensions in metres.
Contour interval = 1.0 m





A gently rising homesite with layered forest and mountain views, Homesite 11 offers a quiet sense of retreat while remaining close to Trailhead's ski-way network. Its natural slope supports creative siting and outdoor terraces that embrace sunlight and surrounding woodland.

HOMESITE VIEWS

- Views of Lizard headwall from Polar Peak to Grizzly Peak
- Tree-filtered views north to Mount Fernie
- Tree-filtered views to Morrissey Ridge
- Distant views south down Elk Valley

NOTABLE SITE FEATURES

- Exceptional views
- Excellent ski-in/ski-out access for Fernie Alpine Resort

These homesite plan are provided for information purposes only and must not be construed as legal surveys. They have been prepared based on the most recent information available at the time and are believed to be true and accurate; however, no warranty as to accuracy is provided by the Developer. The homesite owner must confirm all dimensions, elevations, and other information provided herein. The Developer and its employees, contractors, consultants and agents are not liable for any losses arising from use of this plan. E&OE. See Trailhead's Residential Design Guidelines for requirements related to use of building envelope. Note that contour lines within road rights-of-way represent pre-development grades.

