

TRAILHEAD
HOMESITE 10

0.68 hectares · 6,829 m²
1.69 acres

Following the land's contours, this linear homesite invites a home design that captures downhill views and sunlight throughout the day. Private ski-way access, gentle topography and open-space adjacency create a balance of privacy, connection and architectural opportunity.

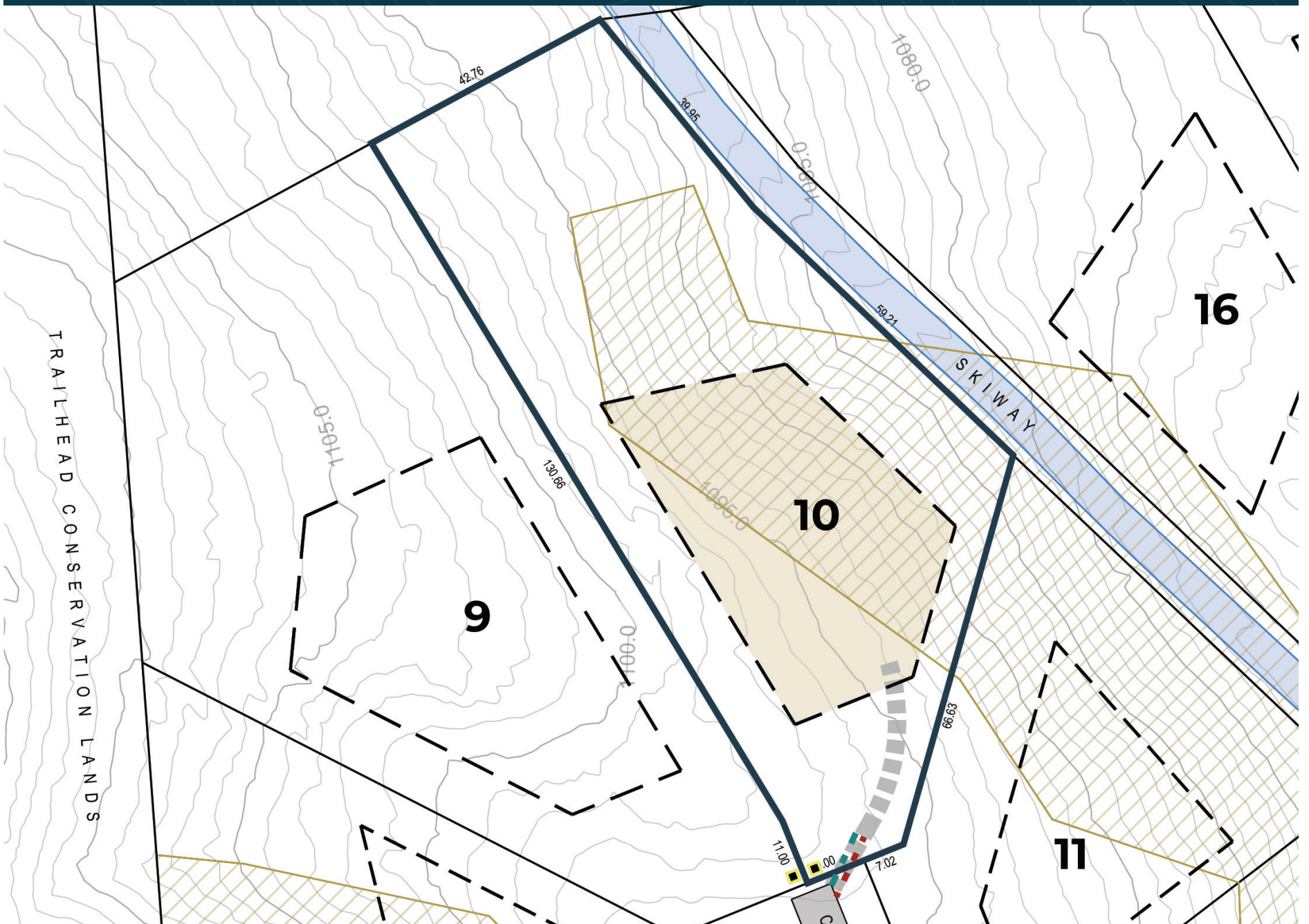

Property Boundary
Building Envelope

All dimensions in metres
Contour interval = 1.0 m

Required Driveway Location
Entry monument & light
Water service location
Sewer service location

Geohazard Zone II
Conditionally suitable for residential structures; site specific review required
Geohazard Zone IIIB
Unsuitable for residential structures



HOMESITE AREA 1.69 acres | 0.68 ha | 6,829 m²
BUILDING ENVELOPE 0.48 acres | 1,934 m²
HOMESITE FRONTAGE 10.0 m | 32.8 ft

SETBACKS

Front yard: 25.0 m | 82.0 ft
Rear yard: As per homesite plan
Side yard (left): 10.0 m | 32.8 ft
Side yard (right): 6.0 m | 19.7 ft



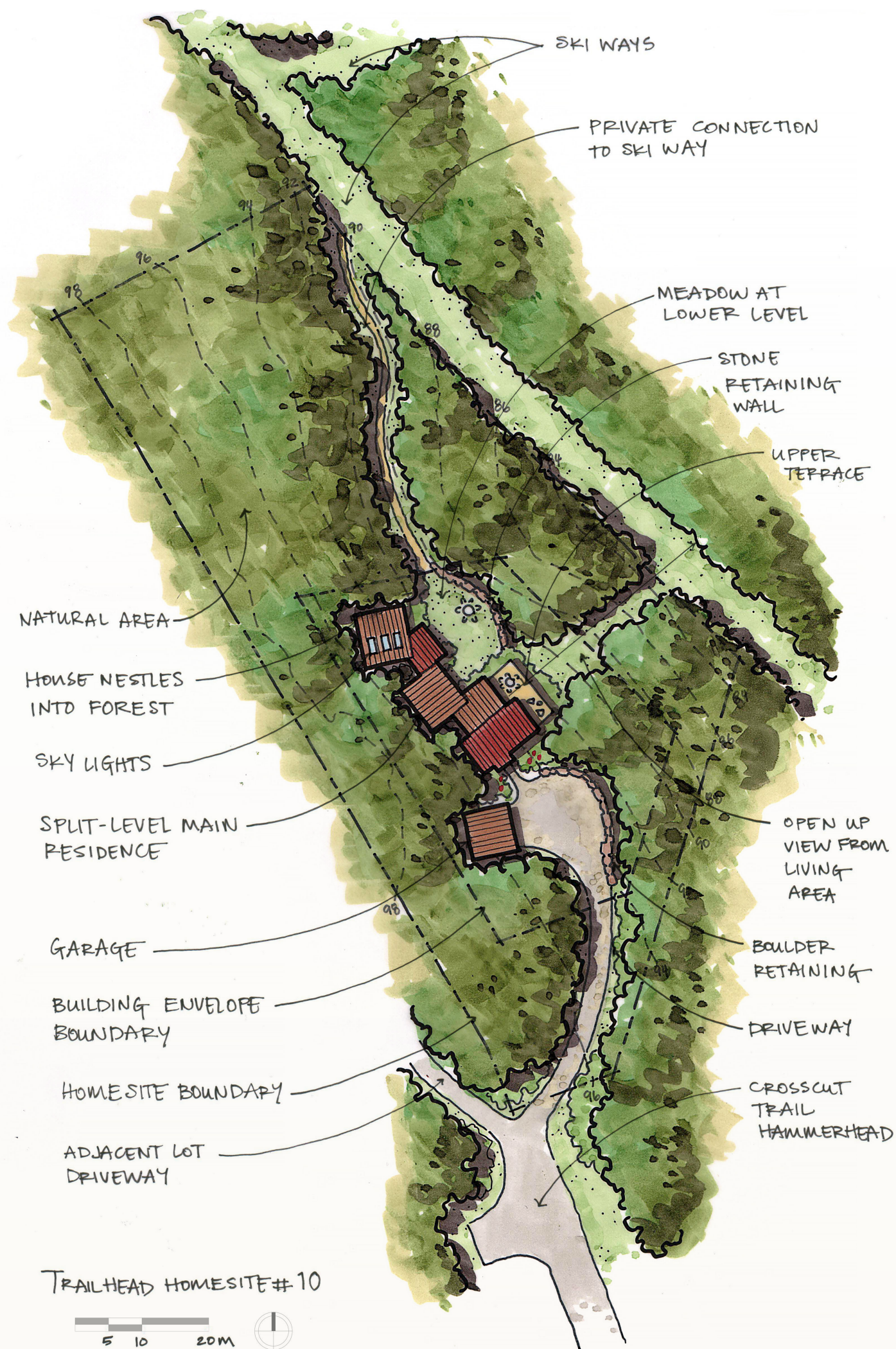

TRAILHEAD HOMESITE #10

HOMESITE VIEWS

- Views of Lizard headwall from Polar Peak to Grizzly Peak
- Tree-filtered views north to Mount Fernie
- Tree-filtered views across the Elk River valley to Morrissey Ridge

NOTABLE SITE FEATURES

- Private connection off of neighbourhood ski-way
- Long, gently sloped driveway off end-of-road hammerhead
- Homesite follows contours, allowing for linear house layout that maximizes downhill views
- Adjacent to open space

These homesite plan are provided for information purposes only and must not be construed as legal surveys. They have been prepared based on the most recent information available at the time and are believed to be true and accurate; however, no warranty as to accuracy is provided by the Developer. The homesite owner must confirm all dimensions, elevations, and other information provided herein. The Developer and its employees, contractors, consultants and agents are not liable for any losses arising from use of this plan. E&OE. See Trailhead's Residential Design Guidelines for requirements related to use of building envelope. Note that contour lines within road rights-of-way represent pre-development grades.

